

1998 Honda CR-V

Submodel: LX | Engine Type: L4 | Liters: 2.0

Fuel Delivery: FI | Fuel: GAS

Rear Differential Assembly

Disassembly

1. Remove the breather tube, the drain plug and the oil filler plug.

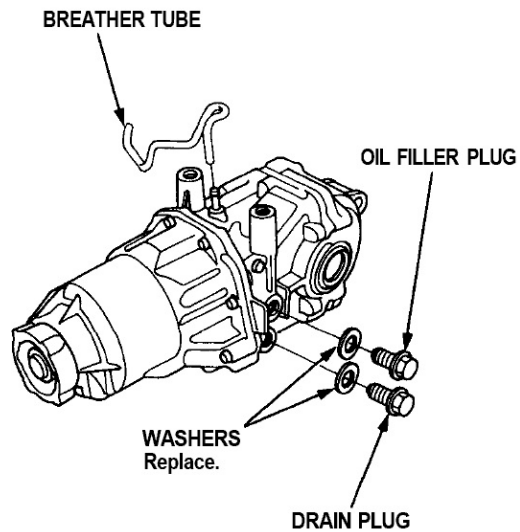

2. Raise the locknut tab from the groove of the clutch guide, making sure that the tab completely clears the groove to prevent damaging the clutch guide.

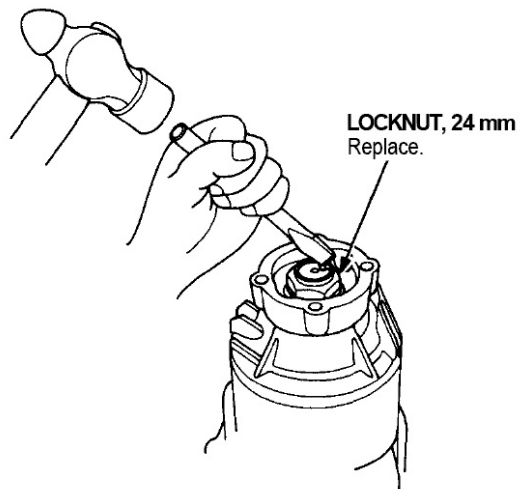

15-20

3. Install the special tools on the companion flange.

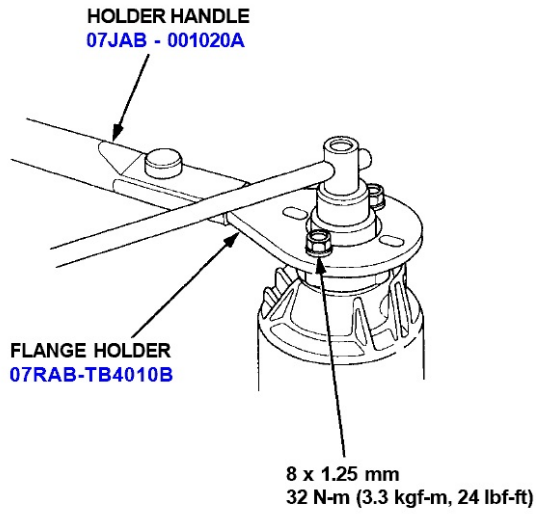

4. Loosen the locknut counterclockwise so that its tab comes out from the groove in the clutch guide.

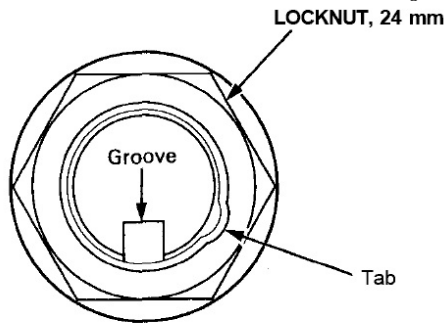

5. Tighten the locknut till its tab aligns with the groove.
6. Remove any dirt from inside of the groove in the clutch guide, then loosen the locknut.

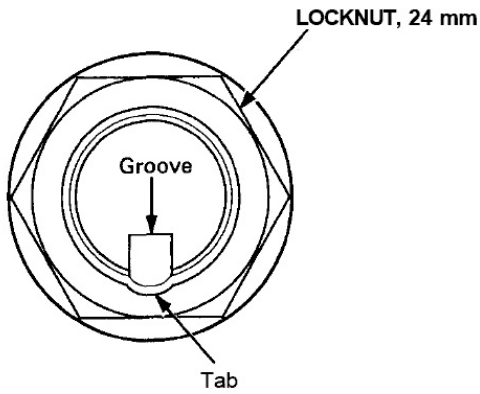

7. Remove the locknut, the disc spring washer, the back-up ring, the O-ring and the companion flange.

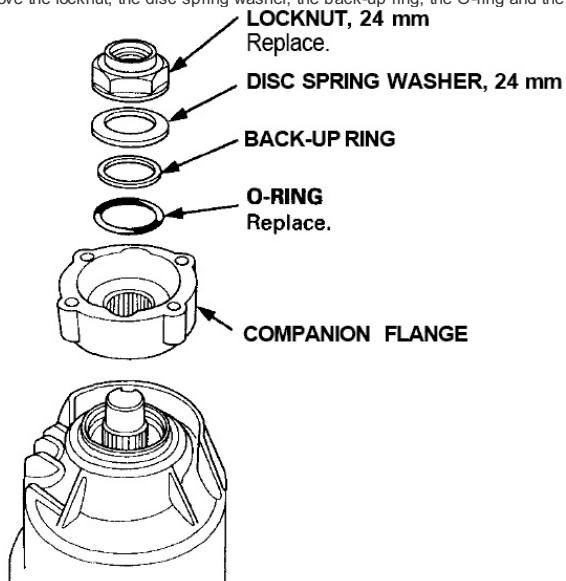

8. Remove the torque control differential case and the dowel pins.

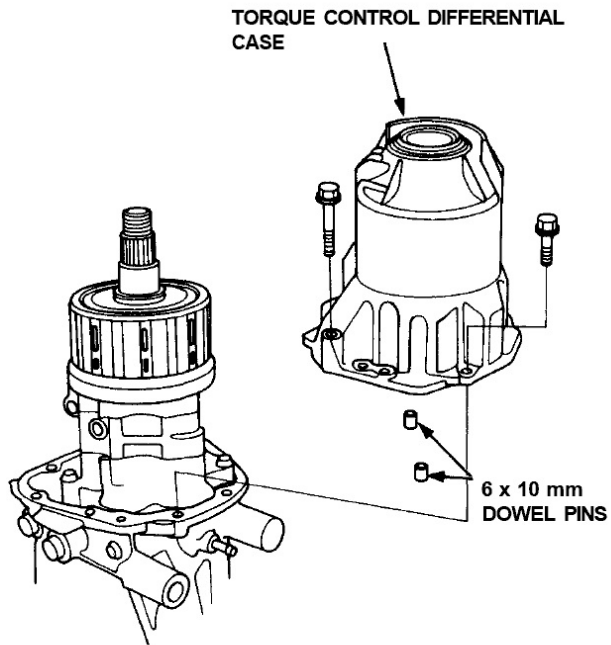

15-21

9. Remove the shim and the clutch guide.

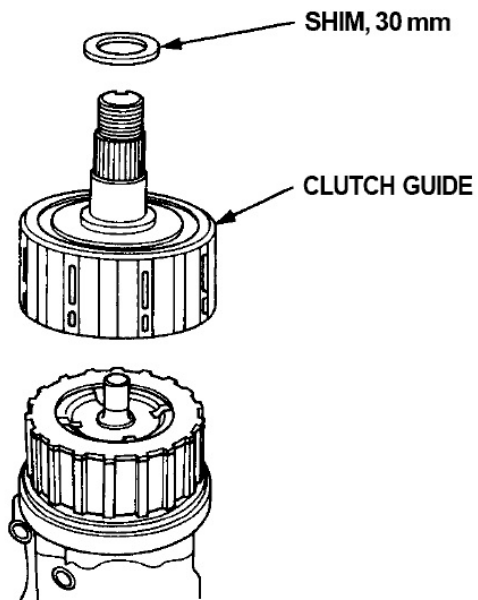

10. Remove the clutch hub/plates/discs and the pressure plate.

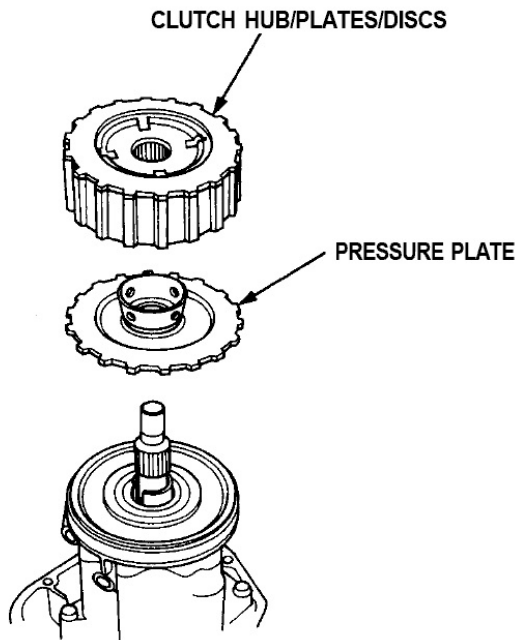

11. Remove the thrust needle bearing and the oil pump driveshaft.

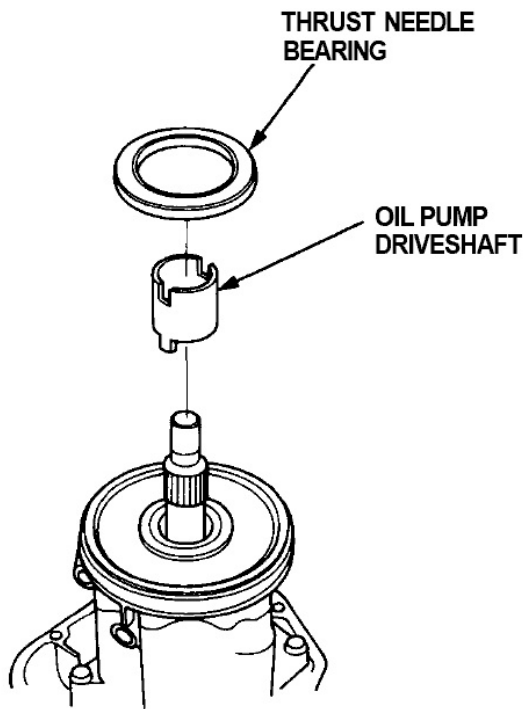

12. Remove the oil pump body assembly, the oil pump pin, the magnet, and the oil strainer.

